

**INTERIOR WALL TYPE LEGEND**

- 1 3 5/8" METAL STUDS @ 16" O.C. W/ 4" S.A. BATTS & 5/8" GYP. BD. BOTH SIDES TO DECKING ABOVE, PAINT
- 2 3 5/8" METAL STUDS @ 16" O.C. W/ 4" S.A. BATTS & 5/8" GYP. BD. BOTH SIDES TO DECKING ABOVE, PAINT SEE DRAWINGS FOR HEIGHTS.
- 3 8" CMU FULL HT TO 2ND FLOOR ABOVE.
- 4 3 5/8" METAL STUDS @ 16" O.C. W/ 4" S.A. BATTS IN WALL, TO DECKING ABOVE. CERAMIC TILE AND CEMENT BOARD WAINSCOT 5'-0" A.F.F.
- 5 6" METAL STUDS @ 16" O.C. W/ 6" BATTS & 5/8" GYP. BD. BOTH SIDES
- 6 8" C.M.U., PAINT
- 7 6" MTL STUDS @ 16" O.C. W/ S.A. BATTS & 5/8" M.R. GYP. BD + F.R.P. BD. ONE SIDE
- 8 3 5/8" MTL. STUDS @ 16" O.C. W/ S.A. BATTS & 5/8" M.R. GYP. BD. + F.R.P. BD. ONE SIDES
- 9 8" CMU WALL FULL HEIGHT WITH 5/8" GYP. BD. ON 1 1/2" HAT CHANNELS 16" O.C. TO 8" ABOVE CEILING ONE SIDE
- 10 3 5/8" METAL STUDS @ 16" O.C. 4" SA BATTS AND 2 LAYERS OF 5/8" GYP. BD. EACH SIDE TO DECKING ABOVE 2 HOUR FIRE BARRIER (UL 411)
- 11 2 3 5/8" METAL STUDS @ 16" O.C. 5/8" M.R. GYP. BD. BOTH SIDES PAINT TO DECK ABOVE, W/ CERAMIC TILE AND CEMENT BOARD TO 52" ABOVE FINISH FLOOR. BOTH SIDES.
- 12 2 3 5/8" METAL STUDS @ 16" O.C. 5/8" M.R. GYP. BD. PAINT TO DECK ABOVE, W/ CERAMIC TILE AND CEMENT BOARD TO 52" ABOVE FINISH FLOOR. BOTH SIDES.ON WET WALL
- 13 8" CMU WALL W/ CERAMIC TILE AT 52" HEIGHT ABOVE FIN. FLR. PAINT ABOVE WAINSCOT

NOTE:  
 1. STUD FRAMING RUNNING TO DECK ABOVE SHALL HAVE SLOTTED HEAD TRACK TO ACCOUNT FOR DECK DEFLECTION.  
 2. VERIFY ALL GIRT AND BUILDING HEIGHTS BEFORE BIDDING ON MTL. STUD AND GYP. BD. FRAMING.

FIRE RATED WALL LEGEND	
	2 - HOUR FIRE BARRIER
	EXISTING 1 - HOUR FIRE PARTITION

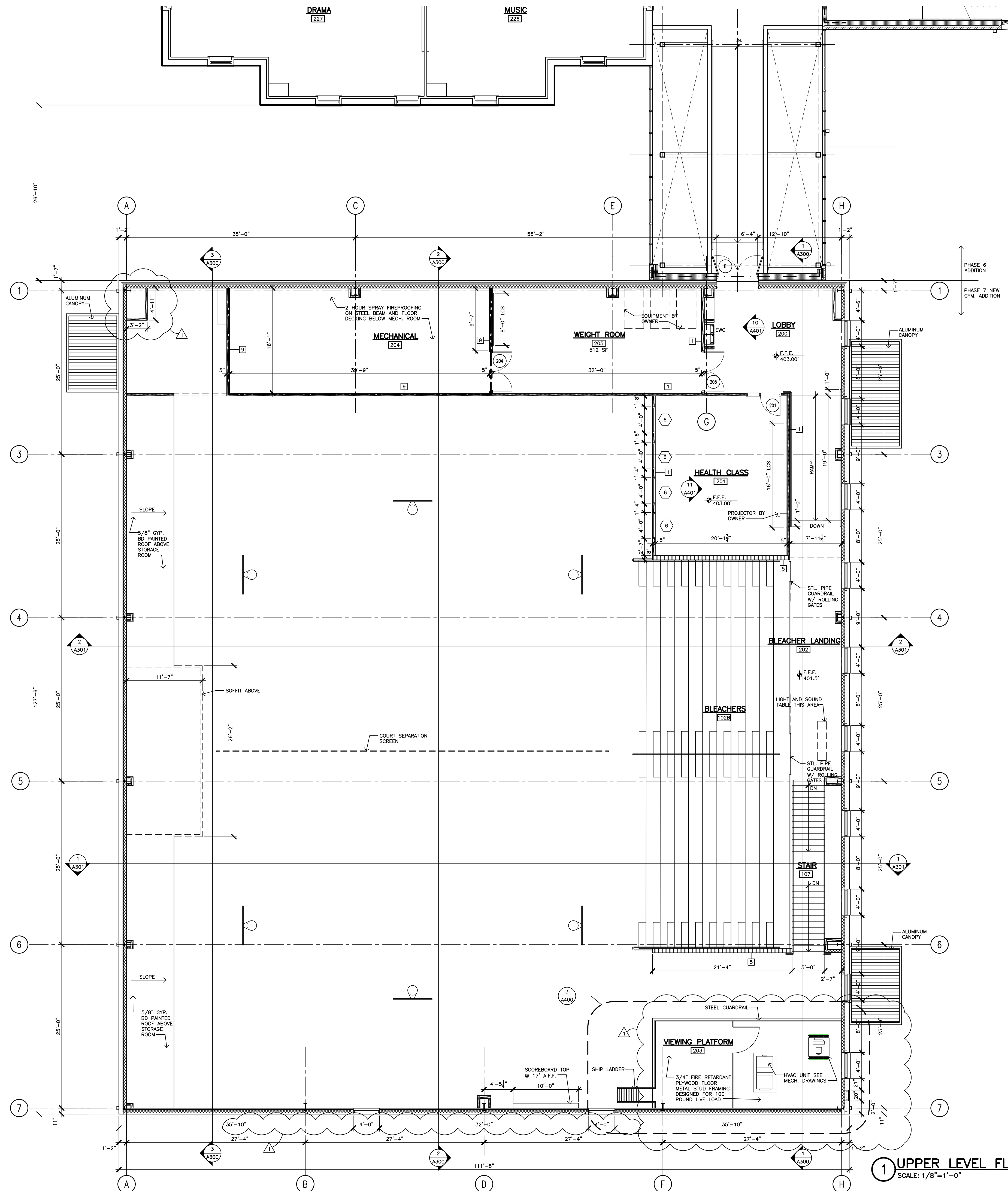

**1 UPPER LEVEL FLOOR PLAN**  
 SCALE: 1/8"=1'-0"

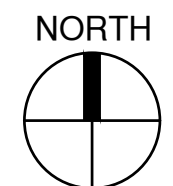

These drawings are instruments of service and as such remain the property of the architect. No copies or reproductions of these drawings are permitted without the consent of the architect. Upon completion of the work all the drawings (except the contract copies) are to be returned to the architect.  
 Copyright © 2021

**UPPER LEVEL FLOOR PLAN**

ADDITIONS TO :

**EXCELSIOR CLASSICAL ACADEMY**

**NEW GYM (PHASE 7)**

4100 N. ROXBORO ST. DURHAM, NC

PROJECT NUMBER 18007

**DTW**  
**Architects & Planners, Ltd.**  
 229 North Gregson Street  
 Durham, NC 27701  
 919.317.4020

ISSUE FOR PRICING  
 Revisions ADD1-04/6/21

Drawn \_\_\_\_\_  
 Checked R.L.S.  
 Date MARCH 21, 2021  
 Sheet \_\_\_\_\_

**A101**  
 Of \_\_\_\_\_