

INTERIOR WALL TYPE LEGEND

- 1 3 5/8" METAL STUDS @ 16" O.C. W/ 4" S.A. BATTS & 5/8" GYP. BD. BOTH SIDES TO DECKING ABOVE, PAINT
- 2 3 5/8" METAL STUDS @ 16" O.C. W/ 4" S.A. BATTS & 5/8" GYP. BD. BOTH SIDES TO DECKING ABOVE, PAINT SEE DRAWINGS FOR HEIGHTS.
- 3 8" CMU FULL HT TO 2ND FLOOR ABOVE.
- 4 3 5/8" METAL STUDS @ 16" O.C. W/ 4" S.A. BATTS IN WALL, TO DECKING ABOVE. CERAMIC TILE AND CEMENT BOARD WAINSCOT 5'-0" A.F.F.
- 5 6" METAL STUDS @ 16" O.C. W/ 6" BATTS & 5/8" GYP. BD. BOTH SIDES
- 6 8" C.M.U., PAINT
- 7 6" MTL. STUDS @ 16" O.C. W/ S.A. BATTS & 5/8" M.R. GYP. BD + F.R.P. BD. ONE SIDE
- 8 3 5/8" MTL. STUDS @ 16" O.C. W/ S.A. BATTS & 5/8" M.R. GYP. BD. + F.R.P. BD. ONE SIDES
- 9 8" CMU WALL FULL HEIGHT WITH 5/8" GYP. BD. ON 1 1/2" HAT CHANNELS 16" O.C. TO 8" ABOVE CEILING ONE SIDE
- 10 3 5/8" METAL STUDS @ 16" O.C. 4" SA BATTS AND 2 LAYERS OF 5/8" GYP. BD. EACH SIDE TO DECKING ABOVE 2 HOUR FIRE BARRIER (UL 411)
- 11 2 3 5/8" METAL STUDS @ 16" O.C. 5/8" M.R. GYP. BD. BOTH SIDES PAINT TO DECK ABOVE, W/ CERAMIC TILE AND CEMENT BOARD TO 52" ABOVE FINISH FLOOR. BOTH SIDES.
- 12 2 3 5/8" METAL STUDS @ 16" O.C. 5/8" M.R. GYP. BD. PAINT TO DECK ABOVE, W/ CERAMIC TILE AND CEMENT BOARD TO 52" ABOVE FINISH FLOOR. BOTH SIDES. ON WET WALL
- 13 8" CMU WALL W/ CERAMIC TILE AT 52" HEIGHT ABOVE FIN. FLR. PAINT ABOVE WAINSCOT

NOTE:
 1. STUD FRAMING RUNNING TO DECK ABOVE SHALL HAVE SLOTTED HEAD TRACK TO ACCOUNT FOR DECK DEFLECTION.
 2. VERIFY ALL GIRT AND BUILDING HEIGHTS BEFORE BIDDING ON MTL. STUD AND GYP. BD. FRAMING.

FIRE RATED WALL LEGEND	
	2-HOUR FIRE BARRIER
	EXISTING 1-HOUR FIRE PARTITION

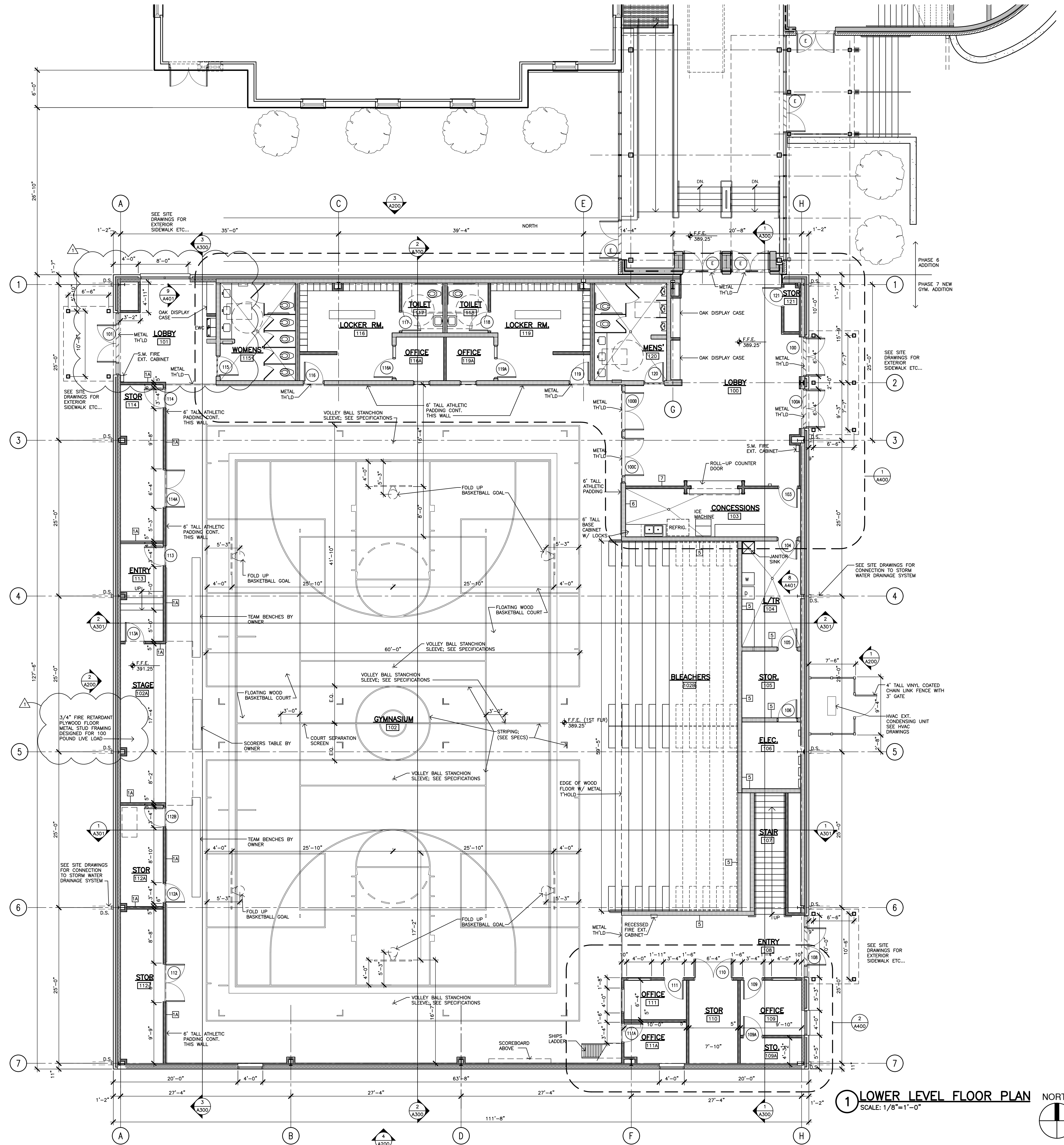

1 LOWER LEVEL FLOOR PLAN
 SCALE: 1/8"=1'-0"
 NORTH

These drawings are instruments of service and as such remain the property of the architect. No copies or reproductions of these drawings are permitted without the consent of the architect. Upon completion of the work all the drawings (except the contract copies) are to be returned to the architect.
 Copyright © 2021

LOWER LEVEL FLOOR PLAN

ADDITIONS TO:
EXCELSIOR CLASSICAL ACADEMY
NEW GYM (PHASE 7)
 4100 N. ROXBORO ST. DURHAM, NC

PROJECT NUMBER 18007

DTW
Architects & Planners, Ltd.
 229 North Gregson Street
 Durham, NC 27701
 919.317.4020

ISSUE FOR PRICING
 Revisions ADD1-04/6/21

Drawn
 Checked R.L.S.
 Date MARCH 21, 2021
 Sheet

A100
 Of